

FLOOR 2

GROSS INTERNAL AREA
 FLOOR 1: 1793 sq ft, 167 m², FLOOR 2: 1847 sq ft, 172 m²
 TOTAL: 3640 sq ft, 338 m²
 SIZES AND DIMENSIONS ARE APPROXIMATE, ACTUAL MAY VARY.

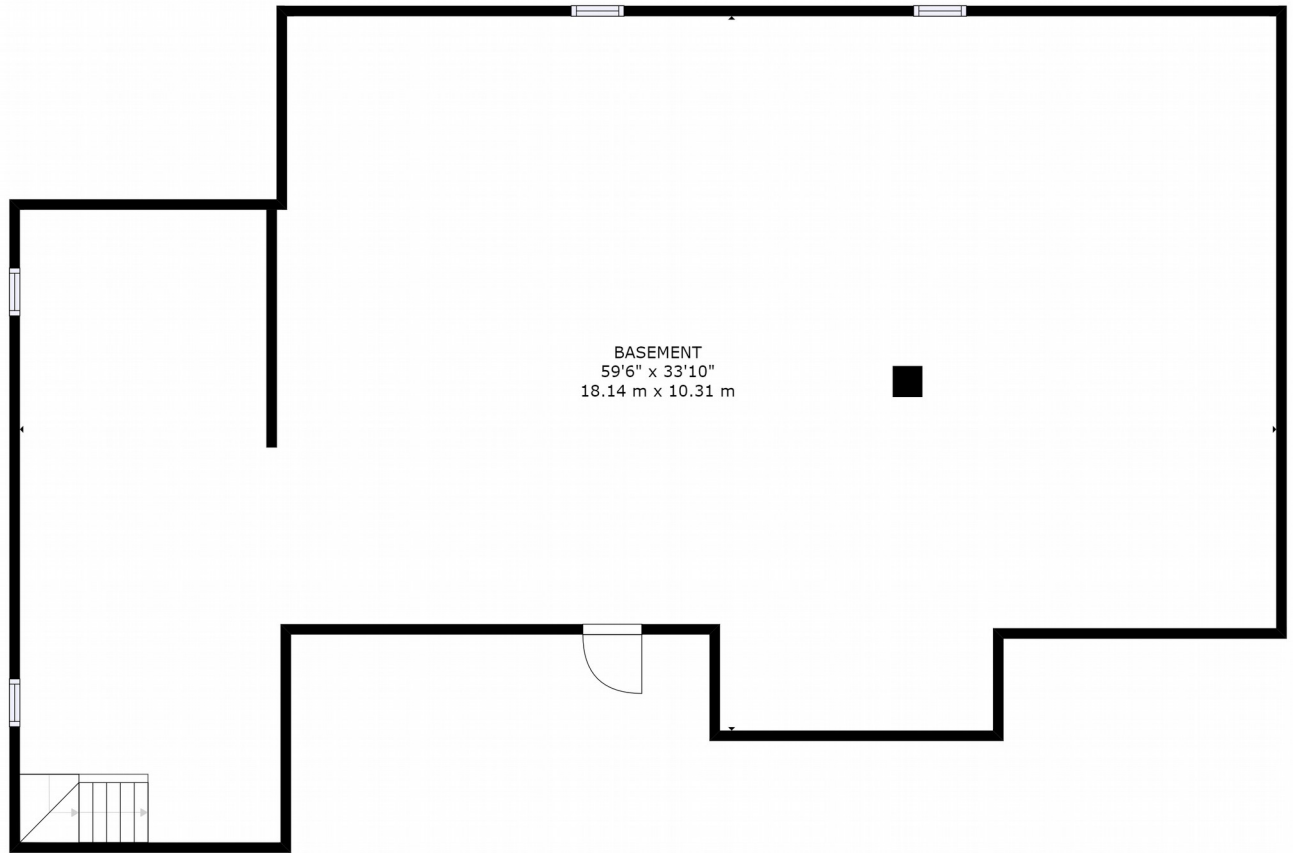



BASEMENT
59'6" x 33'10"
18.14 m x 10.31 m

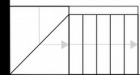

FLOOR 1

GROSS INTERNAL AREA
FLOOR 1: 1793 sq ft, 167 m², FLOOR 2: 1847 sq ft, 172 m²
TOTAL: 3640 sq ft, 338 m²
SIZES AND DIMENSIONS ARE APPROXIMATE, ACTUAL MAY VARY.





GROSS INTERNAL AREA
 FLOOR 1: 1793 sq ft, 167 m²; FLOOR 2: 1847 sq ft, 172 m²
 TOTAL: 3640 sq ft, 338 m²
 SIZES AND DIMENSIONS ARE APPROXIMATE; ACTUAL MAY VARY.